



847 OCEAN VIEW BLVD

PACIFIC GROVE, CALIFORNIA

OCEANFRONT DREAM IN PACIFIC GROVE

\$3,695,000

PacificGroveParadise.com



SCAN ME

Hold up your phone's camera to visit the property's website.

Experience the ultimate coastal lifestyle in this stunning home boasting front-row seats to playful sea otters, breaching whales, and graceful sailboats gliding across the bay. Perfectly positioned on a rare double lot along Pacific Grove's pristine and protected coastline, this residence offers commanding ocean views from nearly every room. Inside, a spacious layout includes 3 bedrooms, 3 bathrooms, a formal dining room, and an extra family room that can easily serve as a fourth bedroom, providing flexibility for guests or extended family. The two-car garage ensures convenience, while the private outdoor spaces invite you to relax and soak in the fresh ocean air. Just steps from the charming boutiques and renowned dining of downtown Pacific Grove, and a short drive to Pebble Beach, Carmel-by-the-Sea, and Monterey Bay Aquarium, this home seamlessly blends tranquil seaside living with walkable access to vibrant local culture. This is more than a home — it is a front-row seat to nature's most spectacular show.



**COLDWELL
BANKER**

831.214.1990 | DRE#00891159
TimAllenProperties.com
Team@TimAllenProperties.com



TIM ALLEN
 PROPERTIES TEAM

The property information herein is derived from various sources that may include, but not be limited to, county records and the Multiple Listing Service, and it may include approximations. Although the information is believed to be accurate, it is not warranted and you should not rely upon it without personal verification. ©2024 Coldwell Banker. All Rights Reserved. Coldwell Banker and the Coldwell Banker logos are trademarks of Coldwell Banker Real Estate LLC. The Coldwell Banker® System is comprised of company owned offices which are owned by a subsidiary of Anywhere Advisors LLC and franchised offices which are independently owned and operated. The Coldwell Banker System fully supports the principles of the Fair Housing Act and the Equal Opportunity Act.

FLOOR PLAN

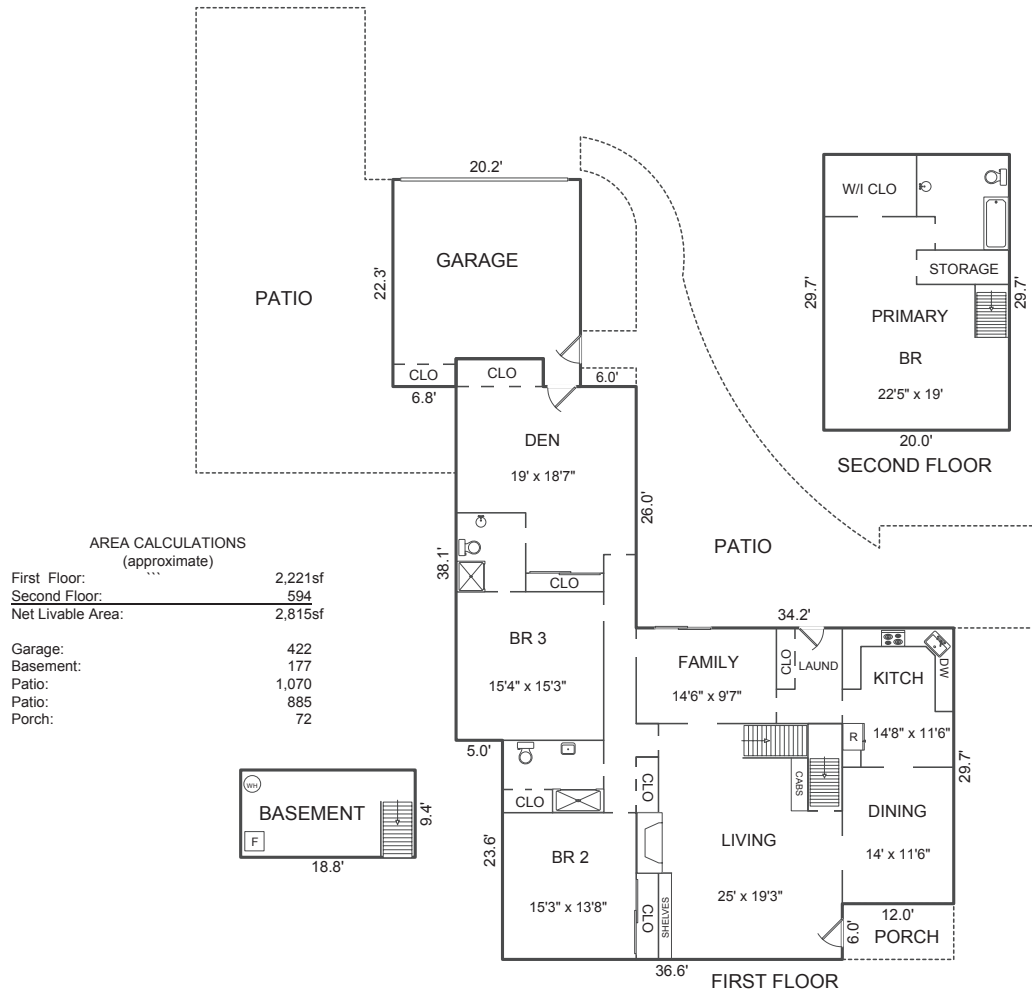

This model is for use as a visual tool only. Some measurements are estimates. Therefore, no appraisal value should be inferred.

SPECIFICS



3 Bedrooms



3 Bathrooms



2,815 SqFt



8,600 SqFt Lot

Interior:Plaster
 Exterior:Wood, Stone
 Fireplace:1
 Heat:Central Forced Air

Roof:Composition Shingle
 Floors:Hardwood, Tile, Carpet
 Garage:2-Car
 Year Built:1956

2.5% Buyers Brokerage Compensation | Brokerage Compensation not binding unless confirmed by separate agreement among applicable parties.